

1" Air Impacttools™ / Rear Handle

NEW

631L – 200 mm anvil

- 4 300 Nm (3 170 ft-lb).
- Swinging-hammer impact mechanism.
- 4-position power regulator.

4 300 Nm !

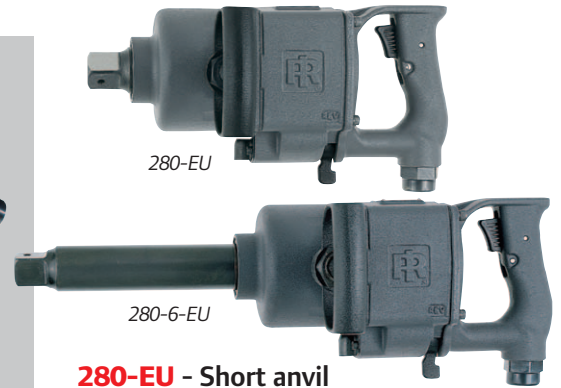

280-EU - Short anvil 280-6-EU - 150 mm anvil

- 2 169 Nm (1 600 ft-lb).
- Jumbo-hammer impact mechanism.

2190Ti - Short anvil, ergonomic chainsaw-type handle

2190Ti-6 - 150 mm anvil, ergonomic chainsaw-type handle

2190DTi-6 - 150 mm anvil, rear handle

- 2 237 Nm (1 650 ft-lb).
- Only 6.13 kg (2190Ti).
- Twin-hammer impact mechanism.
- Titanium hammer case.
- 3-position power regulator.

Accessories: **2190-BOOT** (CPN: 45505419), protective tool boot.

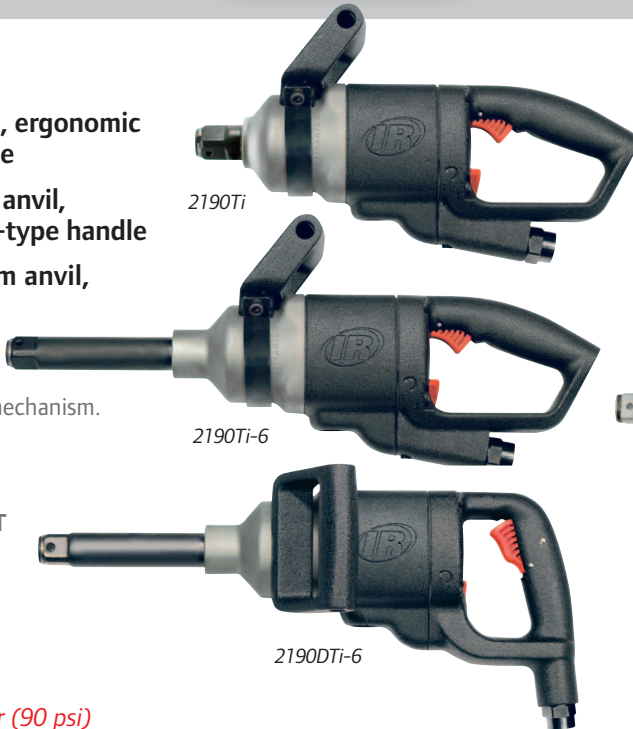

285B - Short anvil 285B-6 - 150 mm anvil

- Designed for operation at 8.3 bar.
- 2 400 Nm (1 700 ft-lb) at 8.3 bar.
- Swinging-hammer impact mechanism.
- 3-position power regulator.

Specifications at 6.2 bar (90 psi)

	CPN	Nm	Max. Nm	1 min. rpm	1 min.	kg	L	AIR	AIR	L/s	Max L/s	dB(A)	m/s ² / K ⁽¹⁾
		Nm	Nm	rpm	mm	kg	mm	NPTF	mm	L/s	L/s	dB(A)	m/s ² / K ⁽¹⁾
1" ■													
631L	80183171	271-3 390	4 300	3 500	700	16.6	624	1/2"	13	7.1	26.4	108.4	12.7 / 2.5
2190Ti	01390459	204-1 356	2 237	6 800	875	6.13	393	1/2"	13	5.6	27.4	103.8	10.4 / 1.5
2190Ti-6	01390467	204-1 356	2 237	6 800	875	7.04	522	1/2"	13	5.6	27.4	103.8	12.7 / 2.9
2190DTi-6	01390475	204-1 356	2 237	6 800	875	7.26	475	1/2"	13	5.6	27.4	103.8	8.7 / 2.1
280-EU	01343193	203-1 356	2 169	6 000	750	9.98	330	1/2"	13	4.7	26.0	109.1	24.1 / 3.4
280-6-EU	01343144	203-1 356	2 169	6 000	750	10.8	470	1/2"	13	4.7	26.0	109.1	21.8 / 3.8
285B	80157209	136-1 220	2 400 ⁽²⁾	5 000	700	11.2	360	1/2"	13	4.7	17.5	99.8	8.0 / 1.2
285B-6	80157233	136-1 220	2 400 ⁽²⁾	5 000	700	12.6	519	1/2"	13	4.7	17.5	99.8	9.0 / 2.7

(1) ISO28927 – 3-axis measurement: vibration level / measurement uncertainty – (2) at 8.3 bar (90 psi).

Service Kits

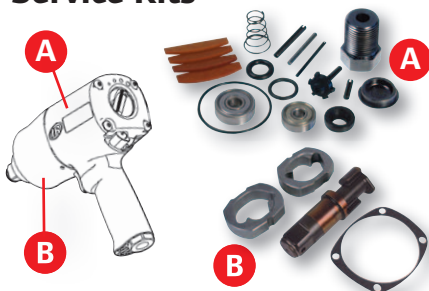

	A	B
631L	45766789	-
2190Ti	80137383	80137698
2190Ti-6	80137383	80137714
2190DTi-6	80137383	80137714
280-EU	03866605	-
280-6-EU	03866605	-
285B	16578965	-
285B-6	16578965	-



SK8M4L (CPN: 81287419): 1" socket set. Contains 4 extended sockets (27, 30, 32 and 33 mm).