

## Tiger Universal Beam Clamp Model No BCU

This product is not for sale in, use in or importation into the United Kingdom

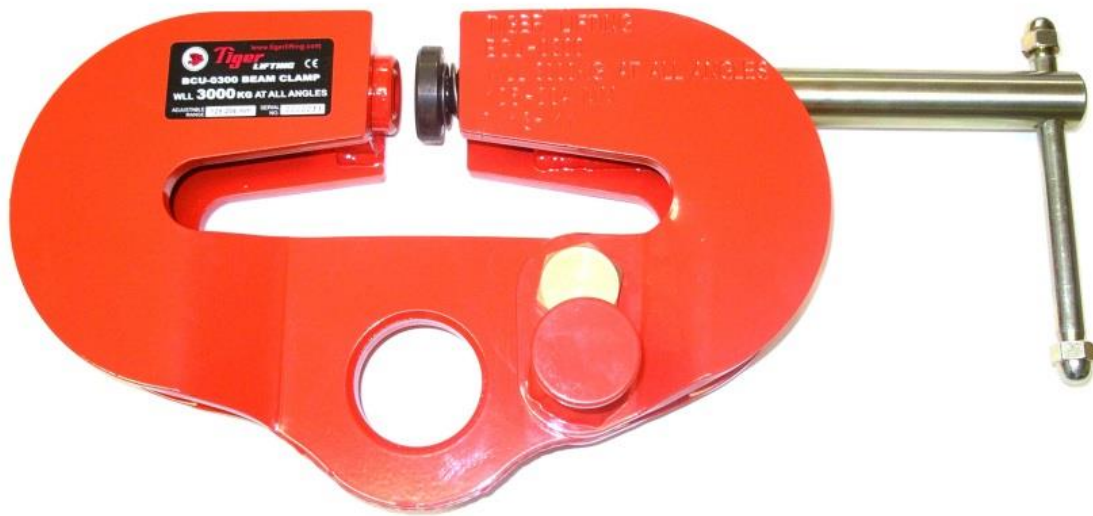

### Main Features

- 3.0t and 5.0t capacities available
- Quick and versatile rigging point for hoisting equipment
- Low headroom design
- Highly flexible – for lifting, pulling or as a semi-permanent anchor point
- Designed for both vertical and side loading applications - can be loaded at any angle
- Suitable for pulling and lifting at angles across the beam
- Full rated capacity at any lifting angle
- Designed to accommodate a wide range of beam widths
- Multidirectional adjusting screw spindle ensures a high clamping force to the various flange sizes within its capacity
- Safety factor of at least 5 times SWL
- Operating temperature of -50°C to +50°C
- Complies with ASME B30.20

**Warning:** Do not exceed working load limits or use this equipment for lifting flat plate sections

-  Australia
-  Taiwan
-  UK

# Tiger Lifting



[www.tigerlifting.com](http://www.tigerlifting.com)

**Tiger**

Home of the Tiger hoisting range & Tiger subsea lifting products

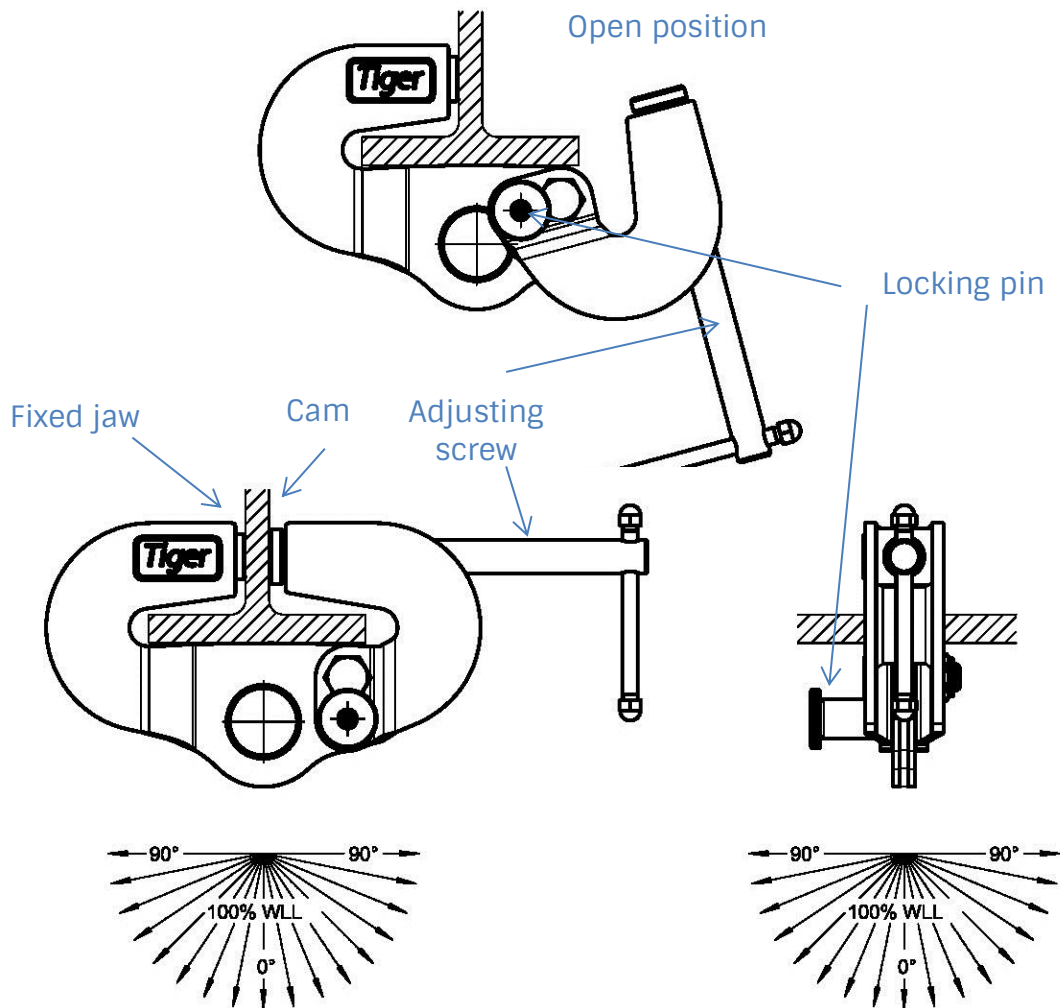

### Certification:

Each unit comes fully certified with a test certificate or an EC Declaration of Conformity stating compliance with the essential health and safety requirements of the Machinery Directive 2006/42/EC.



**Technical Data**

Product Code	Capacity (tonne)	Dimensions (mm)											Weight (kg)
		A	B	C	D	E	F	G	H	J	K	L	
BCU-0300	3.0	387	60	70	48	32	235	100	25.4	28	20	125-204	15.96
BCU-0500	5.0	524	70	74	58	32	270	120	25.4	38	24	125-305	28.96

**Technical Drawing**

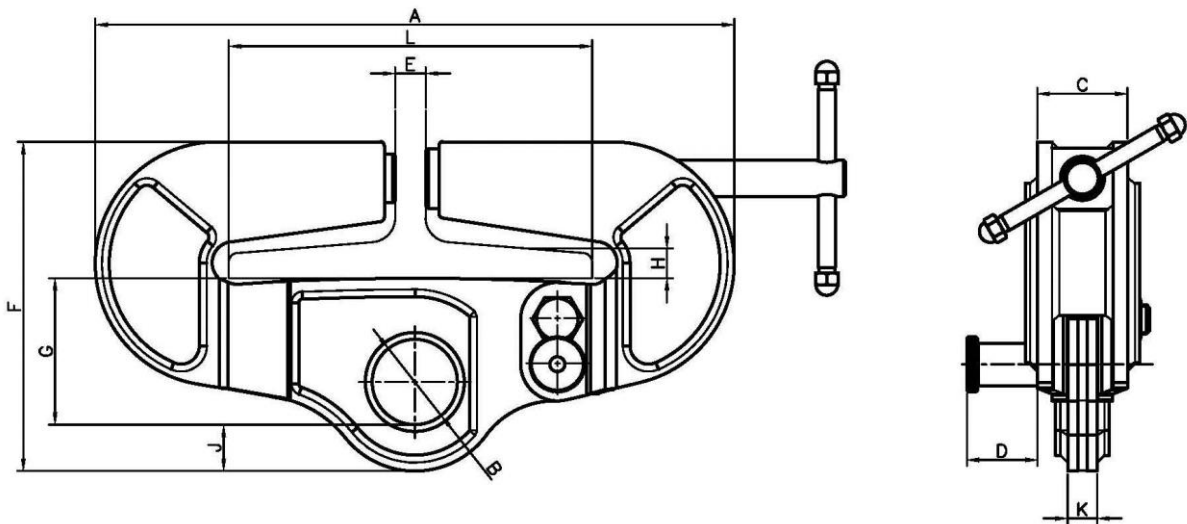

Due to our policy of continual product development, dimensions, weights and specifications may change without prior notice. Please check with your Tiger sales team when ordering.